

BASEMENT-2 (64 NOS. CAR PARKING)
LVL-5600

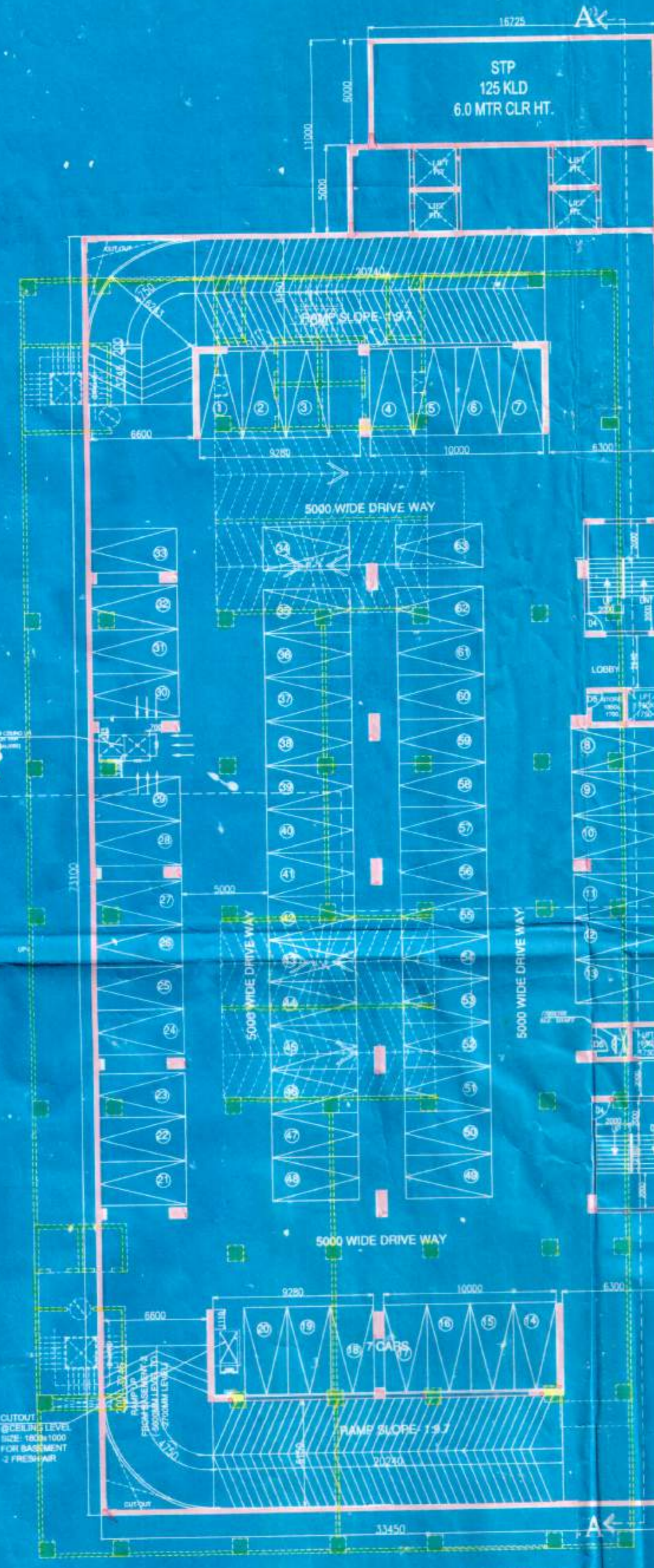

BASEMENT-1 (63 NOS. CAR PARKING)
LVL-2700

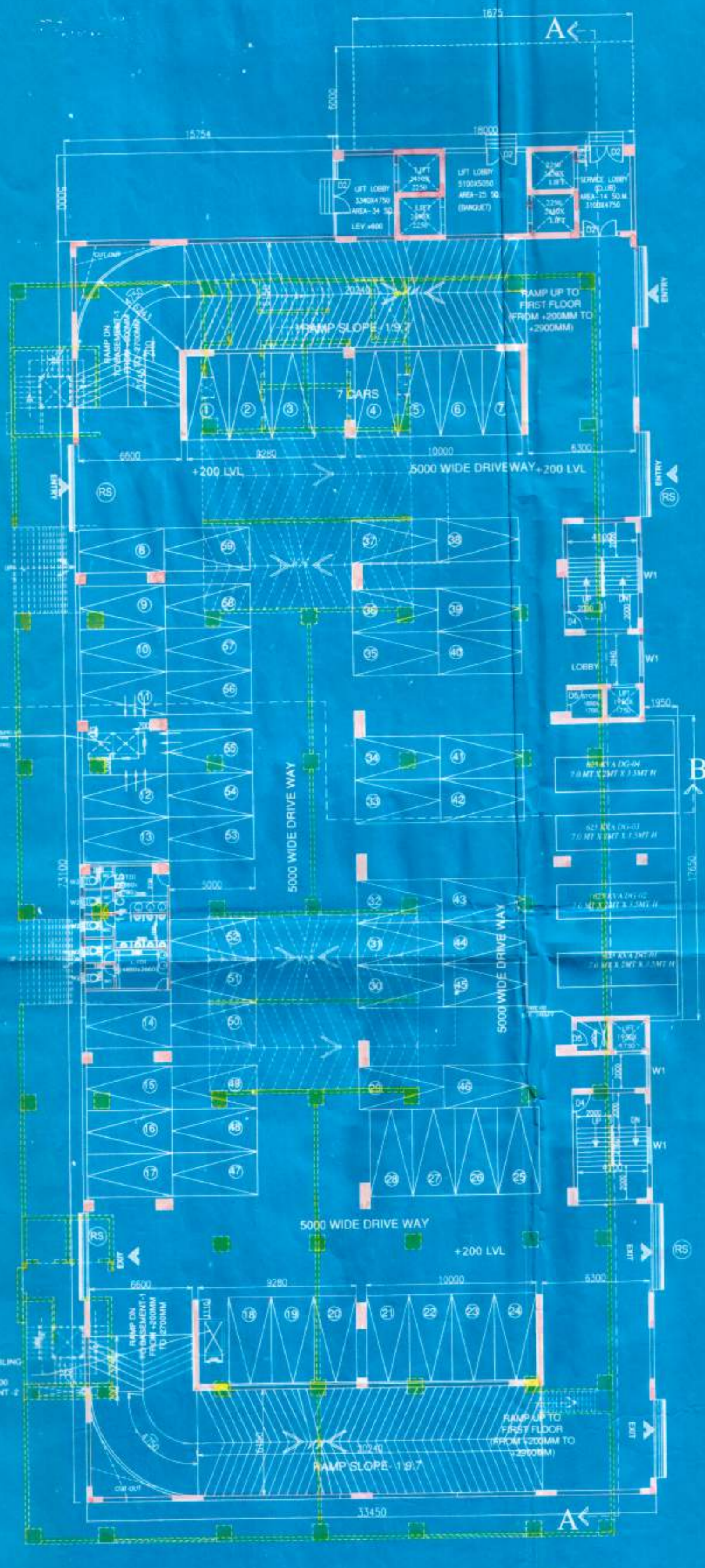

GROUND FLOOR PLAN (59 NOS. CAR PARKING)
LEVEL +100MM

- SPECIFICATIONS:-**
- ALL DIMENSIONS ARE IN MILLIMETRES UNLESS OTHERWISE STATED.
 - ALL EXTERNAL WALLS ARE 200 IN & ALL INTERNAL WALLS ARE 100MM.
 - THE DEPTH OF S.W.D.W.P. & SEPTIC TANK SHALL NEVER EXCEED THE DEPTH OF FOUNDATION.
 - BRICK WORK: 200 IN. MORTAR 1:1 & BRICK WORK 100 IN. MORTAR 1:1.
 - ALL R.C.C. WORKS M.S. EXCEPT FOUNDATION M.S.
 - GRADE OF STEEL FE 415 (S. CODE 1786-1979).
 - ALL SHORTS OF PRE-AUTONOMY MEASURE WILL BE TAKEN AT THE TIME OF CONSTRUCTION.
 - OTHERS ITEM ARE AS PER I.S. SPECIFICATION.

DOORS AND WINDOW OPENING SCHEDULE:-

S/L NO	LEGEND	SIZE	LINTEL HT
01	D1	3000 x 2400	2400
02	D2	1800 x 2100	2100
03	D3	1500 x 2100	2100
04	D4	1800 x 2100	2100
05	D5	900 x 2100	2100
06	D6	900 x 2100	2100
07	W1	2000 x 1200	2100
08	W2	800 x 800	2100

I HEREBY CERTIFY THAT THE ERECTION OF BUILDING ON PREMISES NO. 42B, CHOWRINGHEE ROAD, KOLKATA-700071 IS UNDER MY SUPERVISION. I ALSO CERTIFY THAT THE PROPOSED CHANGES IN STRUCTURE HAVE BEEN MADE BY ME CONSIDERING ALL POSSIBLE LOADS INCLUDING THE SEISMIC LOAD AS PER I.B.C. OF INDIA AND IT IS SAFE AND STABLE IN ALL RESPECTS.

Sumita De
SUMITA DEY
M.C.E., M.I.E., C.E.
ISS/1/93

SIGN. OF STRUCTURAL ENGINEER.

I HEREBY CERTIFY THAT WE HAVE REVIEWED THE STRUCTURAL ANALYSIS FOR PREMISES NO. 42B, CHOWRINGHEE ROAD, KOLKATA-700071, AND THAT THE PROPOSED CHANGES IN STRUCTURE ARE SAFE AND STABLE.

Ujjwal Saha
Ujjwal Saha
B.C.E., M.C.E., M.I.E., C.E.
ISS/1/93

SIGN. OF STRUCTURAL REVIEWER.

WE DO HERE BY UNDERTAKE WITH FULL RESPONSIBILITY THAT: (1) WE SHALL ENGAGE ARCHITECT & E.S.E. DURING CONSTRUCTION & WE SHALL FOLLOW THE INSTRUCTION OF ARCHITECT & E.S.E. DURING CONSTRUCTION OF THE BUILDING (AS PER D.S. PLAN). (2) K.M.C. AUTHORITY WILL NOT BE RESPONSIBLE FOR STRUCTURAL STABILITY OF THE BUILDING & ADJOINING STRUCTURE. (4) IF ANY SUBMITTED DOCUMENTS ARE FOUND TO BE FAKE, THE K.M.C. AUTHORITY WILL REVOKE THE SANCTION PLAN. (5) THE CONSTRUCTION OF WATER RESERVOIR AND SEPTIC TANK WILL BE UNDER THE GUIDANCE OF ARCHITECT & E.S.E.

Subir Kumar Basu
Subir Kumar Basu
Registered Architect
Reg. No. - 0477243292

SIGNATURE OF OWNER.

I HEREBY CERTIFY THAT THE ERECTION OF BUILDING ON PREMISES NO. 42B, CHOWRINGHEE ROAD, KOLKATA-700071 IS UNDER MY SUPERVISION. I ALSO CERTIFY THAT THE PROPOSED CHANGES IN LAYOUT HAS BEEN DRAWN AS PER PROVISION OF K.M.C. BUILDING RULES 2009.

Subir Kumar Basu
Subir Kumar Basu
Registered Architect
Reg. No. - 0477243292

SIGNATURE OF ARCHITECT.

**PROJECT-
REVISED PLAN U/R 25 (2a & 2b) OF K.M.C. BUILDING
RULE 2009 FOR (G + 58) STORED RESIDENTIAL
TOWER OF HT.(234.8 M.) AND 2B+G+V STORED MLCP
WITH CLUB BUILDING OF HT.(19.2 M) AT PRE. NO.
42B CHOWRINGHEE ROAD, KOLKATA-700071,
WARD-63, BOROUGH-VII.**

**THE PREVIOUS BUILDING PERMIT NO.
2013/97281, DATED, 14.12.2011, IS REVALIDATED FOR 5 YEARS, FROM
14/12/17 APPROVED BY D.V. CE(C) BLOC. BR-VII, DATED-16/2/18**

JW CONSULTANTS LLP
PRINCIPAL STRUCTURAL ENGINEER
FOR OFFICE: 101, CHANDRANILAY, 10, FIVE STAR ROAD, BANGALORE-560025
FOR OFFICE: 101, CHANDRANILAY, 10, FIVE STAR ROAD, BANGALORE-560025
ASSOCIATE STRUCTURAL ENGINEER

Sumita De
Mrs. SUMITA DEY
E.C.E. 1/93

**ARCHITECTS :
ARCHITECT HAFEEZ
CONTRACTOR
AND
Subir Kumar Basu**

4, Broad Street, Kolkata - 700019
(T) +91 33 22870553, (F) +91 33 22833043
(E) bhasu_subirkumar@yahoo.com

ARCHITECTURAL

Drawing File: FLOOR PLANS OF M.L.C.P. AND CLUB

Designed	Drawn	Checked	Approved
D.P.A.L	S. CHAKRABORTY	S. K. BASU	

Drawing No: SKBMANICHWMLCPARCKMCR26/07
Sheet No: 7 OF 9
Drawing Date: 14/02/2018